

Waterproof Box Installation and Operation Manual

Safety Guide

1. Suitable for outdoor applications.
2. Avoid foreign objects entering the socket.
3. In case of any malfunction, professional maintenance is required.

Product Features

IP Degree of Protection : IP66

Tools Required for Installation

- M4x27 Phillips pan head screw x4
- M4x30 Phillips pan head screw x4
- M3x8 Phillips countersunk head screw x6
- Bottom box waterproof plug x4
- Top cover waterproof plug x4
- Gasket x3
- Expansion tube x4
- Phillips screwdriver (self-provided)
- Level and ruler (self-provided)
- Marker (self-provided)
- Waterproof connector (self-provided)

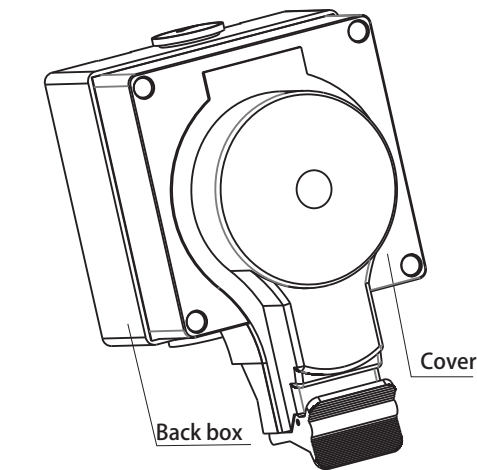

Installation Steps

1. Fixing the Back Box

Method 1:

Use a level to draw a parallel line on the wall. Knock out the mounting holes of the back box. Align the edge of the back box with the parallel line, and mark the center of each mounting holes on the wall with a marker. Drill holes in the wall according to the marked positions. Insert expansion plugs into the holes, and fasten the back box to the wall with screws. Finally, cover the mounting holes of the back box with the waterproof plugs.

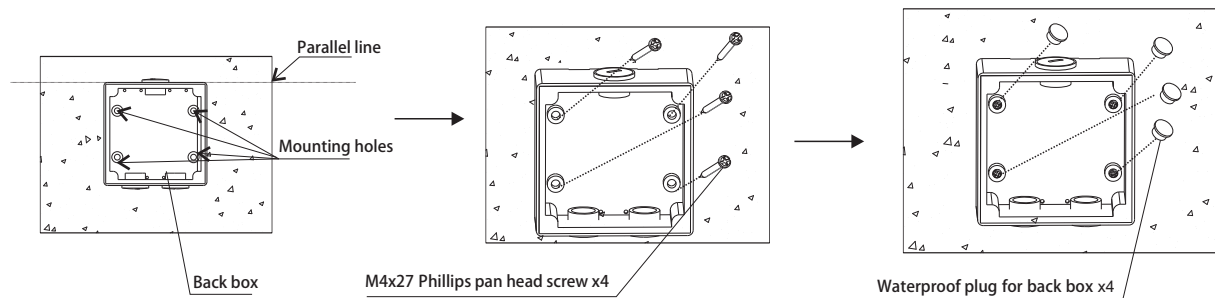

Method 2:

Place the 3 pieces of mounting bracket onto the corresponding positions of the back box and secure them with screws. Use a level to draw a parallel line on the wall. Align the edge of the back box with the parallel line. Mark the positions of mounting bracket holes onto the wall with a marker. Drill holes in the wall according to the marked positions. Insert expansion plugs into the holes, and finally, use screws to fasten the back box securely to the wall.

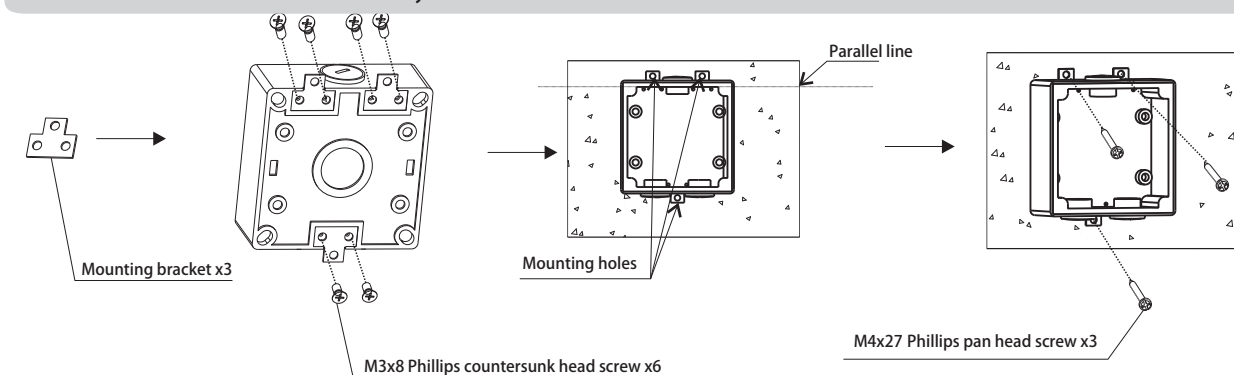

2. Cable Connection

Select the appropriate waterproof connector based on the cable size. Unscrew the plug from the cable outlet of the back box. Feed the power cable through the waterproof connector, and then secure the connector to the cable outlet of the back box.

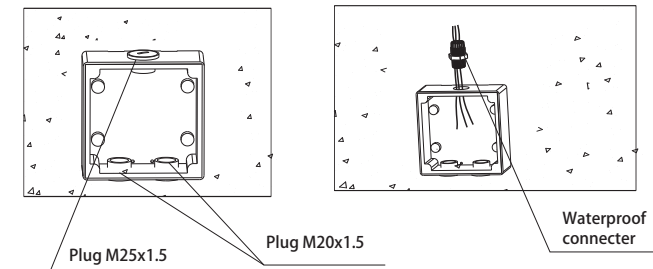

4. Mounting the Cover

Align the screw holes of the cover with those of the back box, and secure the cover to the back box using screws. Finally, cover the screw holes with four waterproof plugs.

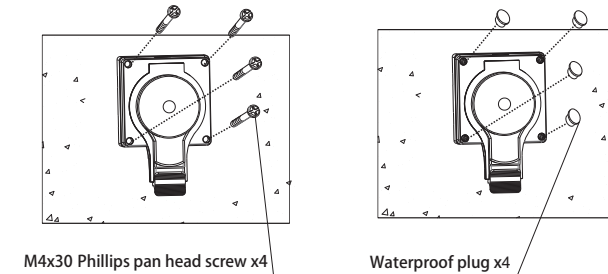

Using the Product

1. Open and Plug

Press the indicated area to open the cover. After plugging in the power cable, position it near the cable outlet and close the cover.

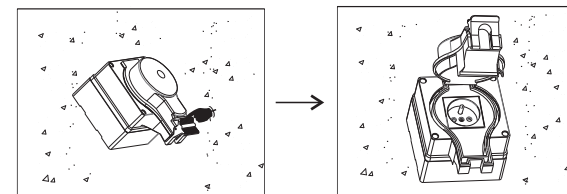

Waterproof Box Installation and Operation Manual

3. Power Module Connection

Connect the power cable to the terminals on the back of the power module.

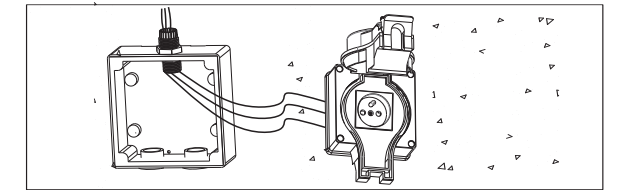

2. End of Use

Open the cover, unplug the power cable, and close the cover. Ensure the latch is properly secured, as shown in the illustration, to prevent water ingress. You can also lock it with a padlock to ensure electrical safety.

